



Safe Student Drop-Off & Pick-Up

Safe:

Taking your time; not hurrying

Opening car doors only when stopped in position #1, #2 or #3

Being alert for quick moving children who are not paying attention to traffic

Unsafe:

Stopping/dropping across the street from Greenspire

Allowing students to walk alongside the car line

U-turns on Red Drive

Procedures

- Approach from the north on Red Drive
- Stay right of the cones
- Do not pick up or drop off in the red area
- Pull up to the furthest possible position indicated in green
- Have your child organize his/her possessions before stopping
- Exit to the south; do not make a U-turn adjacent to the school

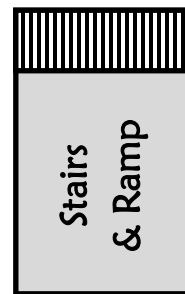
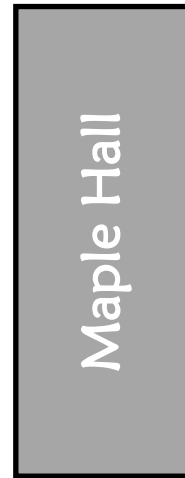
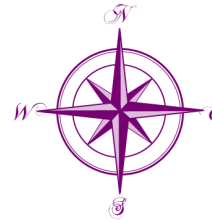

Area Unsafe for Children

